



# Center for Spine Surgery

Certificate of Public Review

Delaware Health Resources Board Proposal

December 17, 2020



# Project Description

## Center for Spine Surgery

- Joint venture partnership formed between ChristianaCare and Delaware Neurosurgical Group
- The only single-focus, comprehensive, full-scope ambulatory outpatient spine surgery center within Delaware and the surrounding area
- Estimated capital expenditure is \$5.2M and includes minor renovation
  - 32,000 square feet
  - Six (6) operating rooms
  - Five (5) overnight rooms with 23-hour stay capacity for spine surgical patients
  - Post-surgical recovery space

# Facility Design

6 Operating Rooms

5 Overnight Stay Rooms

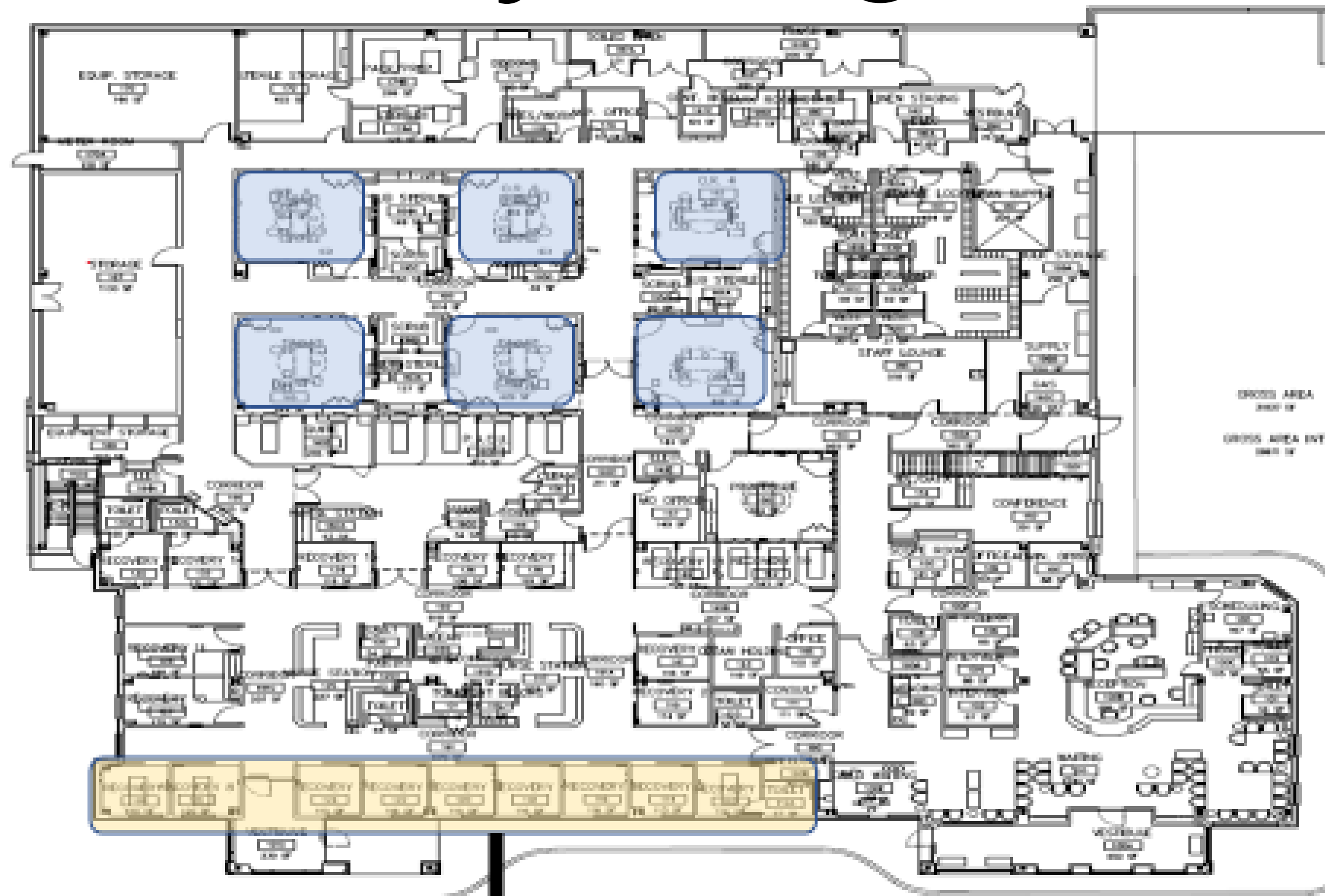

Renovated Design

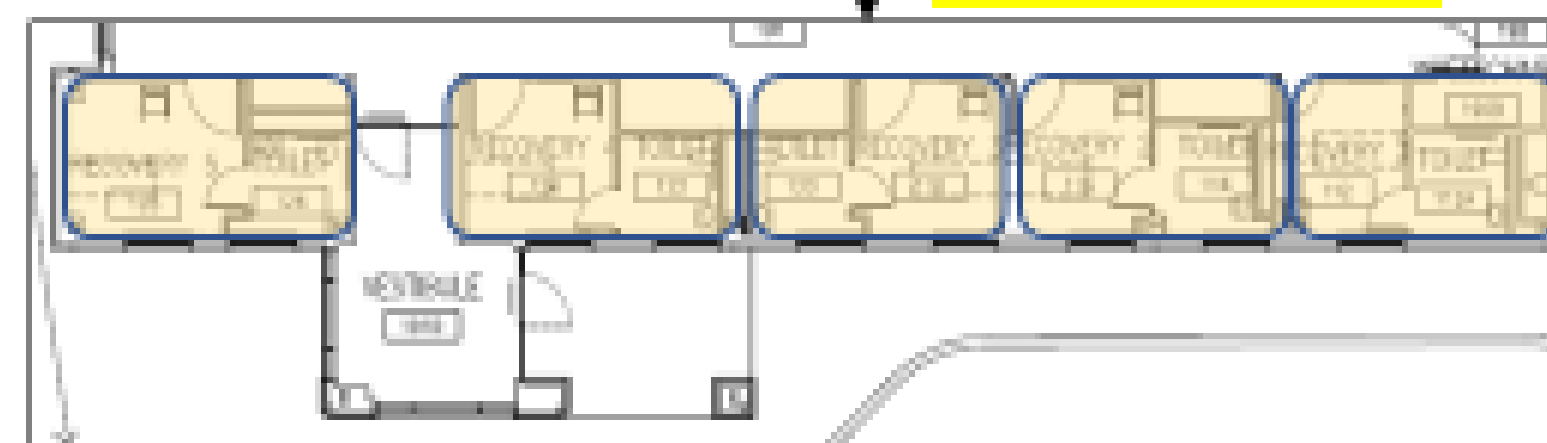

Center for Spine Surgery will be located on the ChristianaCare Wilmington Campus in its existing Roxana Cannon Arsht Surgicenter.



# Conformity with Health Resources Management Plan

## Objectives of the Center for Spine Surgery

- Improve Access: Solely focusing on outpatient spine surgical and pain management procedures
- Reduce Healthcare Costs: Transitioning appropriate spine surgeries from inpatient hospital setting to ambulatory outpatient setting
- Provide High-Quality Healthcare: Establishing a comprehensive spine Center of Excellence



# Projected Utilization

- New Castle County is the primary service area

## Projected Utilization

	<u>Year 1</u>	<u>Year 2</u>	<u>Year 3</u>
Spine Surgery	1,233	1,356	1,492
Pain Management	1,663	1,663	2,497
<b>Total Volume</b>	<b>2,896</b>	<b>3,019</b>	<b>3,989</b>

- Center for Spine Surgery will be a Center of Excellence with care standardization that delivers patient-centered pain management care





# Clinical Impact

- Patients will be medically assessed to determine if the Center for Spine Surgery is the right place for their care, or if inpatient hospital care is best
- Single-focused and patient-centered:
  - Tailored processes, surgery flow, and recovery monitoring specific to the needs of spine surgical patients
- Comprehensive spine procedures (low-acuity to high-acuity) including injections, high-complexity procedures, and fusions



# Effect on Costs and Charges

- Health care payers continue to promote moving patient care from traditional hospital settings to lower-cost, high-quality ambulatory surgery centers
- Health care cost savings to the community in year one of operations is approximately \$13.6 million
- Patients will experience lower out-of-pocket costs, including co-pays and deductibles
- In the first year, annual projected revenue is \$14.8 million and annual projected operating expenses is \$13.9 million



# Schedule of Implementation

Certificate of Occupancy	September/October 2021
Licensing Delaware Department of Health	October/November 2021
Accreditation Association for Ambulatory Healthcare	November/December 2021
CMS Certifications	December 2021/January 2022

**Target Opening Date: January 2022**





**THANK YOU!**